

**Catalogue**  
FOOD SERVICE  
**Chapter**  
COOKING

**Specific model**  
C-E940 400V 3N

19075505

11/11/2021

**DENOMINATION:**

Countertop electric cooker, 4 square plates, 900 range.

**DESCRIPTION :**

- "- Surface tops manufactured in 2 mm thick AISI-304 stainless steel, designed to prevent liquids spilt from the pans from penetrating into the cooker.
- Laser-cut joints, automatic welding and polishes. Screws hidden from view.
- Hot plates manufactured with 300 x 300 mm cast iron, with 4 kW of power, hermetically sealed into the funnelled surface top.
- Power regulation by 7 position selector.
- Safety thermostat for each plate.
- Interior fan to lower the temperature of the components.
- Funnelled surface with rounded corners for easy cleaning.
- High temperature enamelled cast iron flue protector.
- Access to the components from the front.
- Machines with IPX5 grade water protection.
- VOLTAGE: 400 V 3+N. Ask for other voltages
- "

**POSSIBLE OPTIONS :**

- 230 1N- Transformation A 230 V single phase
- 230 III - A 230 V three-phase transformation without neutral
- MARINE - Other machines - Ship transformation - 440 III

**POSSIBLE ACCESSORIES :**

- STANDS 900
- REFRIGERATED STANDS
- ACCESSORIES KORE
- COOKER ACCESSORIES KORE
- KORE WHEELS
- TALL CHIMNEY KORE

**DIMENSIONS**

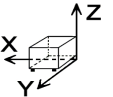

X Width	800 mm	X Gross width	840 mm
Y Depth	930 mm	Y Gross depth	1022 mm
Z Height	290 mm	Z Gross height	535 mm
Net Weight	85,0 kg	Gross Weight	101,0 kg
Net volume	0,220 m3	Gross volume	0,459 m3

**ELECTRICITY TECHNICAL SPECIFICATIONS**

Electric power	16,000 kW
Amperage (A)	32A
Heating power	16,00 kW
Voltage	400V - 3N
Electric frequency	50/60Hz

**CONNECTIONS TECHNICAL SPECIFICATIONS**

Three-phase +N 400V wiring	4X4MM2+T
----------------------------	----------

Catalogue  
**FOOD SERVICE**

Capítulo  
**COOKING**

Modelo  
**C-E940 400V 3N**

19075505

11/11/2021



**C-E920**

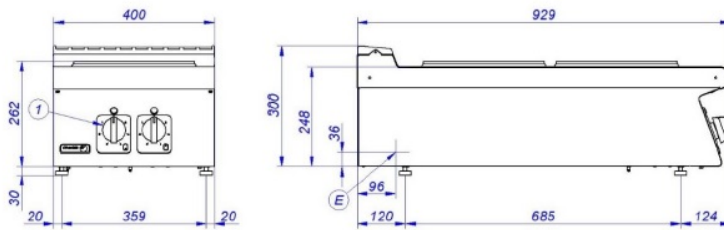

**C-E940**

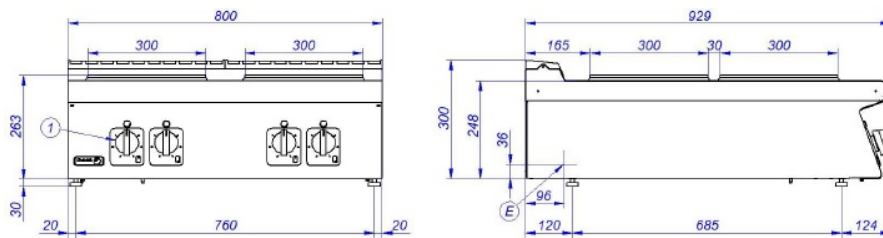

**C-E960**

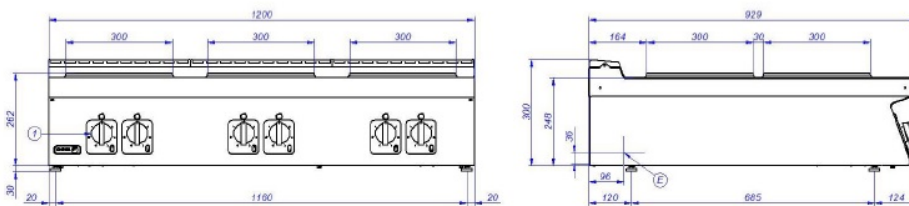

- E. Conexión eléctrica  
1. Mando placas M  
2. Mando horno 1  
3. Mando horno 2

- Electrical connection  
M plates control  
Oven control 1  
Oven control 2