



Catalogue
FOOD SERVICE
Chapter
REFRIGERATION

Specific model
RPS-3G NS 230V 1N 50Hz

19105459

05/07/2024

The photo may show the standard model and not the configured one

DENOMINATION:

Solid worktop saladette with 3 doors.

DESCRIPTION :

- Specially manufactured in high-quality stainless steel for intensive professional applications, featuring a very robust design and perfect finishing.
- Stainless steel drawers with perforated bottom plates and telescopic sliding guides, capable of complete retraction, to economize working surface. Other drawer configurations are also available upon request.
- Static evaporator, foamed in CFC free high-density polyurethane with 40 mm thickness. Interior without fin evaporator and smooth surfaces make an easy to clean compartment.
- Stainless steel doors with ergonomic, full-length, robust, perfectly integrated handle that avoids dust and dirt collection.
- Intuitive, digital display for electronic control with energy saving function to ensure an optimal control of storing products.
- Automatic evaporation of defrost water.
- Removable pull-out/push-in magnetic door gasket to keep maximum hygiene and maintain the insulating properties.
- Forced air cooling system.
- Removable front panel with front breathing design allowing machine to be embedded without penalizing performance.
- Removable and height adjustable epoxy coated GN 1/1 grids with a maximum loading capacity of up to 40 kg.
- 30 mm CFC free polyurethane injected stainless steel worktop without splashback.

POSSIBLE OPTIONS :

- Drawers [1/2] unit
- Remote group

STANDARD OPTIONS :

- Panoramic aperture

POSSIBLE ACCESSORIES :

- ACCESSORIES FOR REFRIGERATION

SUPPLIED ACCESSORIES:

- 19014778 Tray support guides for GN 2/1 double body upright. 3
- 19104363 GN 1/1 epoxy grid for saladette counters. 3

DIMENSIONS

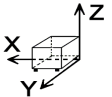

X Width	1358 mm	X Gross width	1410 mm
Y Depth	700 mm	Y Gross depth	760 mm
Z Height	850 mm	Z Gross height	1090 mm
Net Weight	72,0 kg	Gross Weight	82,0 kg
Net volume	0,808 m3	Gross volume	1,168 m3

ELECTRICITY TECHNICAL SPECIFICATIONS

Electric power	0,267 kW
Voltage	230V
Phases	1N
Electric frequency	50Hz
Amperage (A)	1,53A

COLD HORECA ECO LABEL

Energy Efficiency Index	68,82 %
Temperature	+2 +8 °C
Climate class	4
Refrigeration power	0,369 kW
Gas type	R-290
GWP	3
Cooling gas load	98,000 g
Noise level	57,40 dB
Condensation system	Vent.
Model Type	Counter Cabinet
Annual elec. consumption	1608,19 kWh
Power consumption 24h	4,41 kWh
Refrigeration net.vol	214 L
Clasif. Energy efficiency	D

CONNECTIONS TECHNICAL SPECIFICATIONS

230 V three-phase wiring	3X1,0MM2
--------------------------	----------

OTHERS

Number of doors	2
-----------------	---





Catalogue
FOOD SERVICE
Chapter
REFRIGERATION

Specific model
RPS-3G NS 230V 1N 50Hz

19105459

05/07/2024

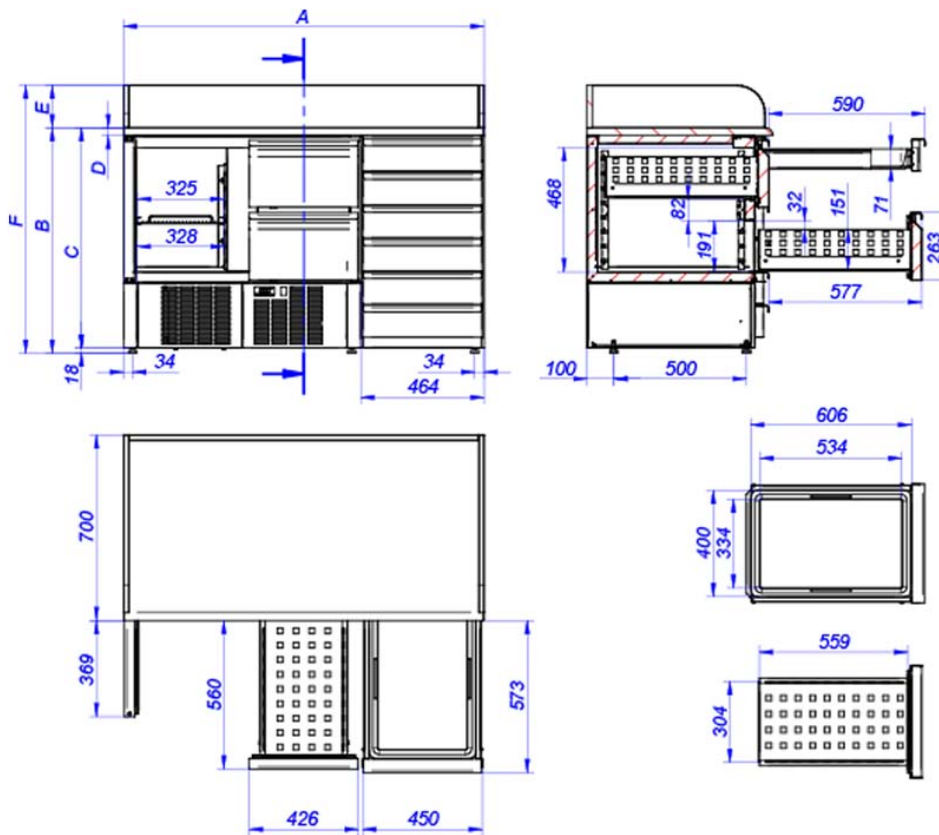

Model	A (mm)	B (mm)	C (mm)	D (mm)	E (mm)	F (mm)						
RPS-2GP	894	840	822	20	21	861						
RPS-2G NS		850	832	30	-	850						
RPS-2G NS HH					290	1140						
RPS-2G NS DH							105	955				
RPS-2GS					160	1010						
RPS-2GZ	1358	850	832	30	21	861						
RPS-3GP							-	850				
RPS-3G NS									290	1140		
RPS-3G NS HHH											105	955
RPS-3G NS DHH												
RPS-3G NS DDH					160	1010						
RPS-3GS												
RPS-3GZ												
RPS-3G GR												
RPS-3G GR D6												