



**Catalogue**  
FOOD SERVICE  
**Chapter**  
OVENS

**Specific model**  
K-A-101-E R K 400V 3N 50/60Hz

19103866

20/12/2024

**DENOMINATION:**

iKORE Kompact DirectSteam (injection) oven with basic wash for 10 GN 1/1 trays electric with right opening and connectivity.

**DESCRIPTION :**

**FUNCTIONS:**

- FagorTouch: 10.1" glass state of the art touch screen for easy and intuitive operation
  - iCooking: Smart cooking process with automatic adjustment:
    - . Options at the end of the cooking process: maintain temperature, repeat cooking process, etc.
    - . Ability to modify smart cooking processes in progress and adjust parameters at any time
  - iFunctions: Intelligent cooking processes with automatic adjustment (regeneration, sous vide, overnight cooking, fermentation, pasteurisation, smoking, charcuterie and dehydration). Smart cooking processes with automatic adjustment
  - iClima:
    - . Humidity management and control by means of direct measurement with a humidity sensor
    - . 1% regulation capacity
  - Fagor Cooking Center:
    - . 200 factory preset and culinary tested recipes
    - . Ability to manage your favourite recipes
    - . Unlimited 9-stage recipe storage capacity
  - Air and water cool-down (rapid cabinet cooling function)
  - Multitray
  - Cooking modes: low temperature steam 30-98°, steam 99°, super steam 100- 130°, mixed 20-300° and convection 20-300°
  - Chamber dehumidification for crispy roasting
  - DeltaT cooking for delicate cooking
- DIRECTSTEAM:**
- Steam generation by injecting water into the turbine, atomising the water and converting it into steam.
- CONTROLS:**
- EasyCooking: option to configure the programmes by password
  - Languages: 36
  - Ability to configure screen tone, volume and contrast
  - Melodies: 8
  - Power, network and language settings
  - Integrated help functions and instruction manual
  - Control and monitoring of the equipment from mobile devices via FagorKonnnect
  - SAT and Trade fair mode
- EQUIPMENT FEATURES:**
- Stop/start function
  - EZ-Sensor. Internal probe with 4 measuring locations
  - Positioning aid for temperature sensor
  - Manual steam injection
  - Automatic dehumidification system
  - Variable humidification with 5 levels
  - 6 programmable air circulation speeds (from 1400 rpm to turbine stop)
  - Option to switch from °C to °F
  - Energy consumption display
  - Display of actual values and selected values
  - Delayed programming
  - IIT (just in time) programming

**DIMENSIONS**

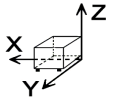

X Width	520 mm	X Gross width	579 mm
Y Depth	810 mm	Y Gross depth	918 mm
Z Height	940 mm	Z Gross height	1107 mm
Net Weight	130,0 kg	Gross Weight	160,0 kg
Net volume	0,400 m3	Gross volume	0,588 m3

**ELECTRICITY TECHNICAL SPECIFICATIONS**

Electric power	12,800 kW
Voltage	380-415V
Phases	3N
Electric frequency	50/60Hz
Amperage (A)	25A
Engine power	0,80 kW
Heating power	12,00 kW

**WATER TECHNICAL SPECIFICATIONS**

Pressure	H2O: 200-400kPa(2-4bar)
Water max consumption	10,00 L/h
Maximum Temperature	Water Inlet Max Temp:60°C

**CONNECTIONS TECHNICAL SPECIFICATIONS**

Three-phase +N 400V wiring	3X4MM2 +N+T-25A
Water inlet diameter	3/4"
Cold softened water 1 diameter	3/4"
Drain 1 diameter	40

**OTHERS**

Door opening	Right
IPX	IPx4





**Catalogue**  
FOOD SERVICE  
**Chapter**  
OVENS

**Specific model**  
K-A-101-E R K 400V 3N 50/60Hz

19103866

20/12/2024

- Ability to select 1/2 power
- Automatic adaptation to the characteristics of the installation site (altitude, etc.) including initial self-testing
- Automatic boiling point adjustment
- Removable fan cover
- Integrated turbine brake for increased safety
- HA-Control: bidirectional turbine that provides intelligent even heat distribution
- Auto-reverse system for reversing fan rotation
- Triple-glazed, ventilated cooking chamber door (all except 0623 and Kompact)
- Special heat-reflective coating and hinged inner panes for easy cleaning
- LED lighting in the cooking chamber
- HOLD-OPEN DOOR systems (3 door locking positions for user safety)
- Proximity contact door switch
- Easily replaceable gasket insert
- Interior and outer material: AISI 304 stainless steel (interior mirror polished)

**CERTIFICATION AND INSTALLATION SYMBOLS:**

- EC declaration of conformity
- EC declaration of gas conformity
- CB safety
- IPX5 protection against splashes and jets of water
- Height adjustable equipment feet (all except 0623 and Kompact)
- Monitor App and maintenance App (self-diagnosis of warnings and errors)

**Logging App:**

- . Cycle history
- . Error history

**FAGORKONNECT:**

- Wi-Fi and ETHERNET connection as standard
- Functions when the oven is or not connected to the internet.

**WASHING SYSTEM:**

- Basic Washing System (simple and economical)
- Washing programmes:
  - . 2 basic cleaning programmes (spray)
  - . 1 rinsing programme
- Option to activate dirt softening during the cleaning process
- Option to activate drying in the cleaning process
- Indication of cleaning status and remaining time
- Control and monitoring of the cleaning process from mobile devices via FagorKonnnect
- Connectivity (K) included (Wi-fi and Ethernet).

**SPECIFIC OPTIONS :**

- ELECTRIC POWER : 400V 3N 50/60HZ - 101
- FUSE DEFINITION : K-101 E
- BRAND : FAGOR
- DOOR OPENING : R RIGHT
- WASHING SYSTEM : BASIC WASH
- SHOWER : NO
- SOUS VIDE & THERMAL PROBE : NO
- CONNECTIVITY : K-WITH IOT CONNECTIVITY
- CERTIFICATION : CE
- REG4 : NO REG4

**POSSIBLE ACCESSORIES :**





**Catalogue**  
FOOD SERVICE  
**Chapter**  
OVENS

**Specific model**  
K-A-101-E R K 400V 3N 50/60Hz

19103866

20/12/2024

- EXHAUST HOOD
- VARIOUS
- SPECIFIC FOR 0623
- COOKING ACCESSORIES O





**Catalogue**  
FOOD SERVICE  
**Chapter**  
OVENS

**Specific model**  
K-A-101-E R K 400V 3N 50/60Hz

19103866

20/12/2024

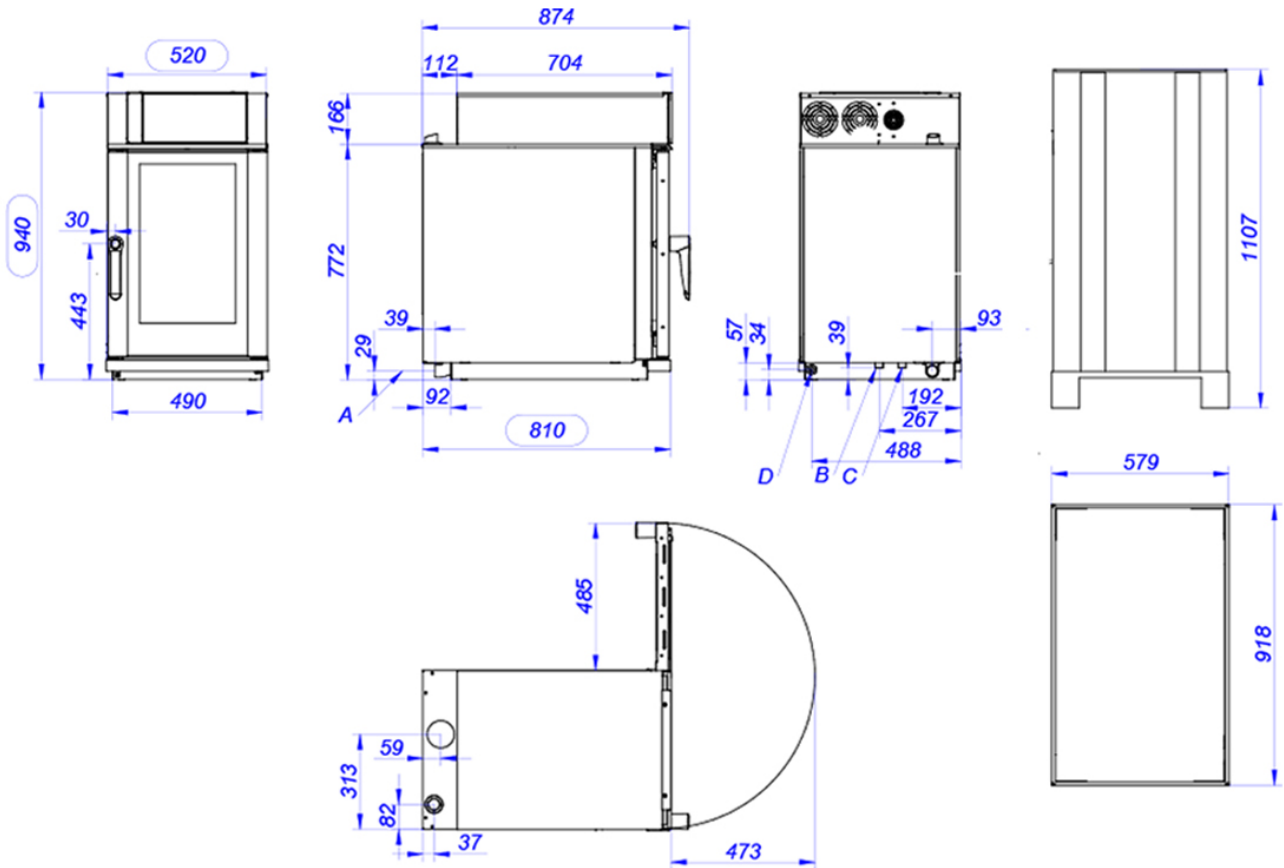

- A: DESAGUE DN40
- B: ENTRADA DE AGUA BLANDA
- C: ENTRADA DE AGUA BLANDA
- D: ALIMENTACION ELECTRICA
- E: ETHERNET
- A: EGOUTTER DN40
- B: ENTREE D'EAU DOUCE
- C: ENTREE D'EAU DOUCE
- D: PUISSANCE
- E: ETHERNET
- A: DRAIN CONNECTION DN40
- B: SOFT WATER CONNECTION
- C: SOFT WATER CONNECTION
- D: ELECTRICAL SUPPLY
- E: ETHERNET
- A: ABLASSEN DN40
- B: WEICHEM WASSERZULAUF
- C: WEICHEM WASSERZULAUF
- D: POWER
- E: ETHERNET
- A: SCARICO DN40
- B: INGRESSO DELL'ACQUA DOLCE
- C: INGRESSO DELL'ACQUA DOLCE
- D: POTENZA
- E: ETHERNET